

PLAT OF SURVEY

DOCUMENT WITH THIS EXHIBIT

1104031029 2 of 10

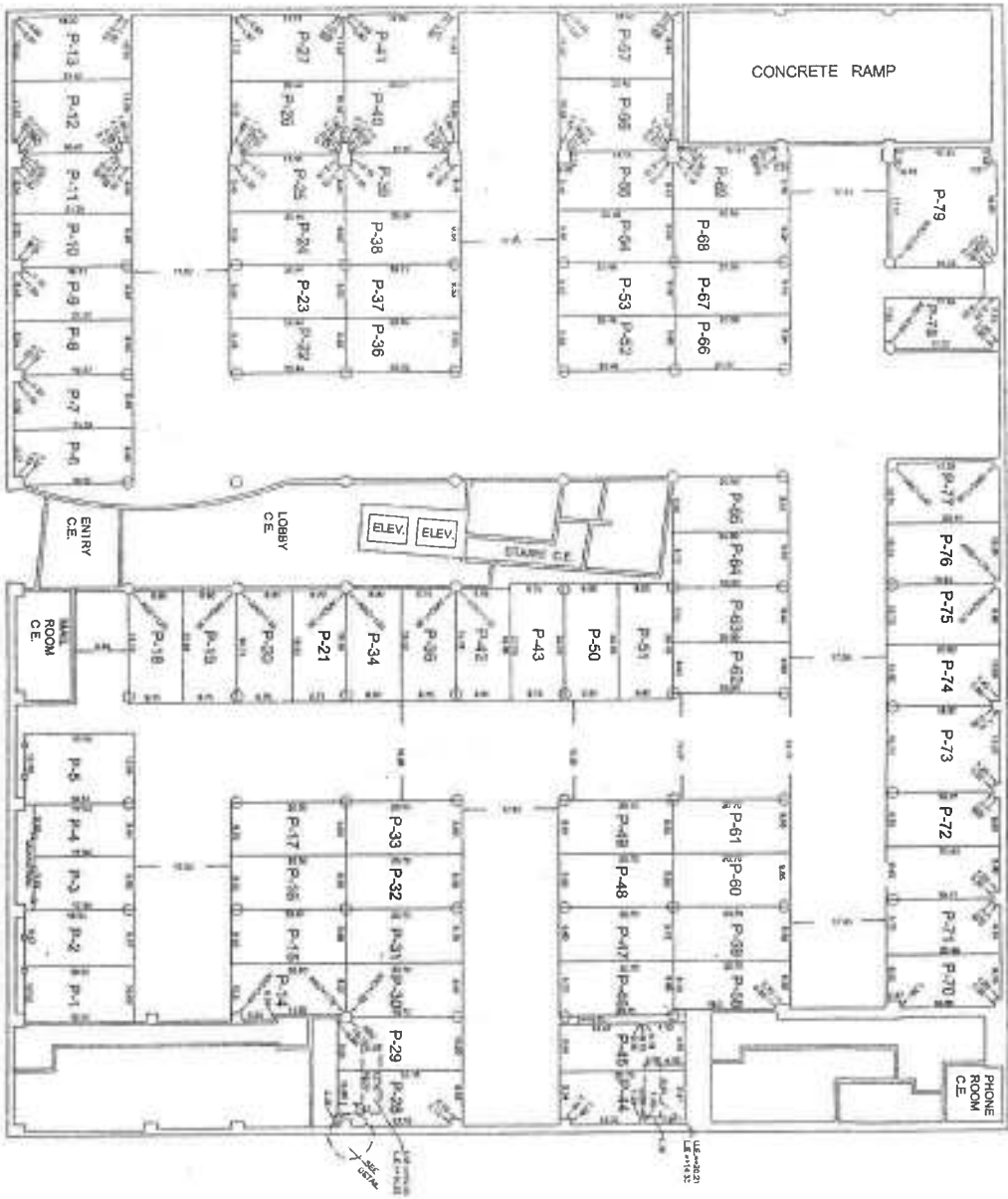

E. INDICATES LIMITED COMMON ELEMENT
INDICATES COMMON ELEMENT

1st FLOOR

ORDER No. 0697
EXHIBIT A
PAGE 2

- P-14, P-15, P-17, P-21, P-29 AND P-94 AMENDED APRIL 16, 2007
- P-19, P-21, P-26 AND P-27 AMENDED MAY 1, 2007
- P-15, P-32, P-43 AND P-26 AMENDED MAY 16, 2007
- P-31, P-38, P-49 AND P-26 AMENDED MAY 25, 2007
- P-8 AND P-60 AMENDED JUNE 12, 2007
- P-43 AMENDED JULY 13, 2007
- P-61 AMENDED AUGUST 2, 2007
- P-28, P-30, P-33, P-72 AND P-74 AMENDED SEPTEMBER 21, 2007
- P-4 AND P-48 AMENDED OCTOBER 16, 2007
- P-34 AMENDED NOVEMBER 4, 2007
- P-20 AMENDED AUGUST 26, 2008
- P-7 AMENDED JULY 20, 2008
- P-9 AMENDED JULY 20, 2008
- P-68 AMENDED OCTOBER 14, 2008
- P-11, P-22, P-23, P-24, P-25, P-26 & P-27 AMENDED JUNE 21, 2010
- P-1, P-2, P-3, P-4, P-5, P-6, P-10, P-12, P-13, P-14, P-29, P-35, P-36, P-37, P-38, P-40, P-41, P-44, P-45, P-47, P-52, P-53, P-56, P-57, P-58, P-60, P-61, P-64, P-65, P-67, P-52, P-53.



HORIZONTAL PLANES SHOWN HEREON ARE MEASURED FROM THE TOP OF UNFINISHED FLOOR TO THE BOTTOM OF UNFINISHED CEILING. VERTICAL PLANES SHOWN HEREON ARE MEASURED FROM INTERIOR FACE OF UNFINISHED PERIMETER WALLS. ELEVATIONS SHOWN HEREON ARE IN RELATION TO:
BENCHMARK No. 582
LOCATED ABOUT 200 FEET NORTH OF NORTH LINE OF W. ADAMS STREET AND ABOUT ONE EAST LINE OF S. RACINE AVENUE. MARK CUT AT SOUTHWEST CORNER OF STONE WINDOWWELL, ON WEST SIDE OF 2 STORY BRICK BUILDING, MARK IS 3.3 FEET ABOVE SIDEWALK ELEVATION ==+16.622
UPPER ELEVATION ==+21.33 ON THIS PAGE ONLY.
LOWER ELEVATION ==+14.33 ON THIS PAGE ONLY.

STATE OF ILLINOIS
COUNTY OF COOK, SS
WE, CERTIFIED SURVEYOR INC., HEREBY CERTIFY THAT WE HAVE SURVEYED THE ABOVE DESCRIBED PROPERTY, LOCATED THE BUILDING THEREON AND DIVIDED BOTH VERTICALLY AND HORIZONTALLY INTO UNITS AS SHOWN ON THIS PLAT WHICH IS A TRUE AND CORRECT REPRESENTATION OF SAID SURVEY. ALL DISTANCES, DIMENSIONS AND ELEVATIONS ARE GIVEN IN FEET AND DECIMAL PARTS OF A FOOT. THIS PROFESSIONAL SERVICE CONFORMS TO THE CURRENT ILLINOIS MINIMUM STANDARDS FOR BOUNDARY SURVEYS AND CONDOMINIUMS. DATED THIS 8th DAY OF DECEMBER, A.D. 2008

LICENSE EXPIRES NOVEMBER 30, 2008