

CERTIFIED SURVEY, INC.

1440 Renaissance Drive, Suite 140, Park Ridge, IL 60068 Phone 847-296-6900 Fax 847-296-6906
PLAT OF SURVEY

11040 2004 7 01

DOCUMENT WITH
 THIS EXHIBIT

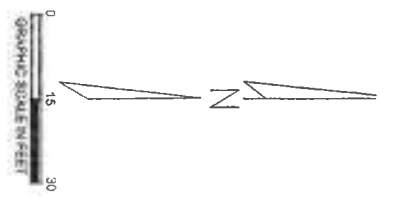

DATE: 11/20/03
 DRAWN BY: J. J. JONES
 CHECKED BY: J. J. JONES
 PROJECT: 1440 RENAISSANCE DRIVE, SUITE 140, PARK RIDGE, ILLINOIS 60068
 (1440 RENAISSANCE DRIVE, SUITE 140, PARK RIDGE, ILLINOIS 60068)

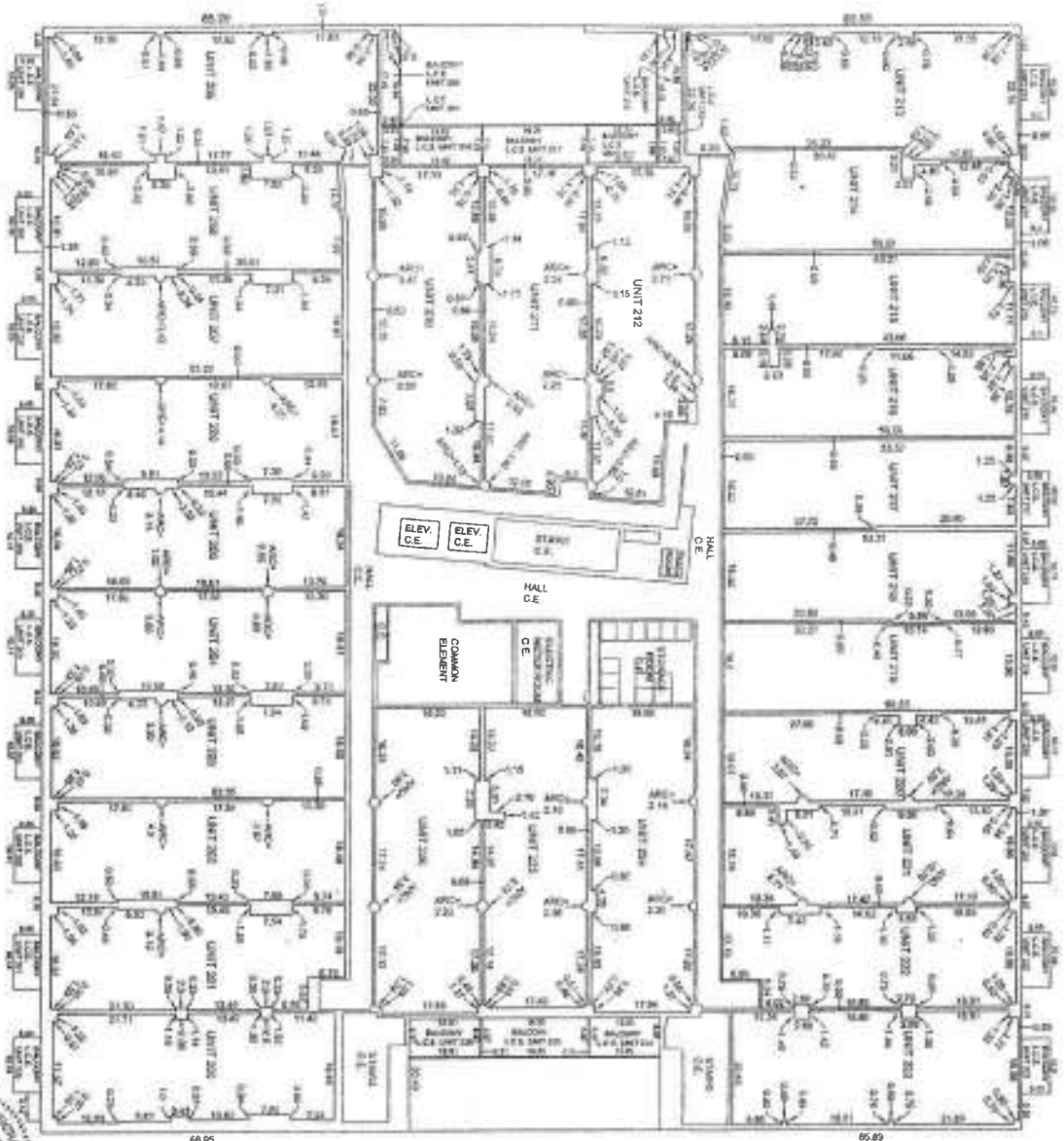

UNIT 217 AND 220 AMENDED APRIL 16, 2007
 UNIT 224, 225 AND 228 AMENDED MAY 1, 2007
 UNIT 218 AMENDED MAY 1, 2007
 UNIT 223 AMENDED JULY 13, 2007
 UNIT 207, 202, 203 AND 204 AMENDED JUNE 12, 2007
 UNIT 219 AMENDED SEPTEMBER 21, 2007
 UNIT 205 AMENDED MAY 14, 2008
 UNIT 208 AMENDED JANUARY 24, 2011

2nd FLOOR

ORDER No. 0697
 EXHIBIT A
 PAGE 4



HORIZONTAL PLANES SHOWN HEREON ARE MEASURED FROM THE TOP OF UNFINISHED FLOOR TO THE BOTTOM OF UNFINISHED CEILING.
 VERTICAL PLANES SHOWN HEREON ARE MEASURED FROM INTERIOR FACE OF UNFINISHED PERIMETER WALLS.
 ELEVATIONS SHOWN HEREON ARE IN RELATION TO:
 BENCHMARK No. 5682
 LOCATED ABOUT 4.5 FEET NORTH OF NORTH LINE OF W. ADAMS STREET AND ABOUT ON EAST LINE OF S. RACINE MARK CUT AT SOUTHWEST CORNER OF STONE WINDOVHILL ON WEST SIDE OF 2 STORY BRICK BUILDING. MARK IS 3 FEET ABOVE SIDEWALK ELEVATION --+18.622
 UPPER ELEVATION --+45.80 ON THIS PAGE ONLY
 LOWER ELEVATION --+32.0 ON THIS PAGE ONLY

STATE OF ILLINOIS
 COUNTY OF COOK SS
 WE, CERTIFIED SURVEY INC., HEREBY CERTIFY THAT WE HAVE SURVEYED THE ABOVE DESCRIBED PROPERTY, LOCATED THE BUILDING THEREON AND DIVIDED BOTH VERTICALLY AND HORIZONTALLY INTO UNITS AS SHOWN ON THE ATTACHED PLAT WHICH IS A TRUE AND CORRECT REPRESENTATION OF SAID SURVEY. ALL DISTANCES, DIMENSIONS AND ELEVATIONS ARE GIVEN IN FEET AND DECIMAL PARTS OF A FOOT. THIS PROFESSIONAL SERVICE CONFORMS TO THE CURRENT ILLINOIS MINIMUM STANDARDS FOR BOUNDARY SURVEYS AND CONDOMINIUMS DATED THIS 8th DAY OF DECEMBER A.D. 2008

PROFESSIONAL SURVEYOR
 J. J. JONES
 LICENSE NO. 001-002777
 COMMISSION EXPIRES 12/31/08