

1440 Renaissance Drive, Suite 140, Park Ridge, IL 60068 Phone 847-296-0900 Fax 847-296-8906

PLAT OF SURVEY

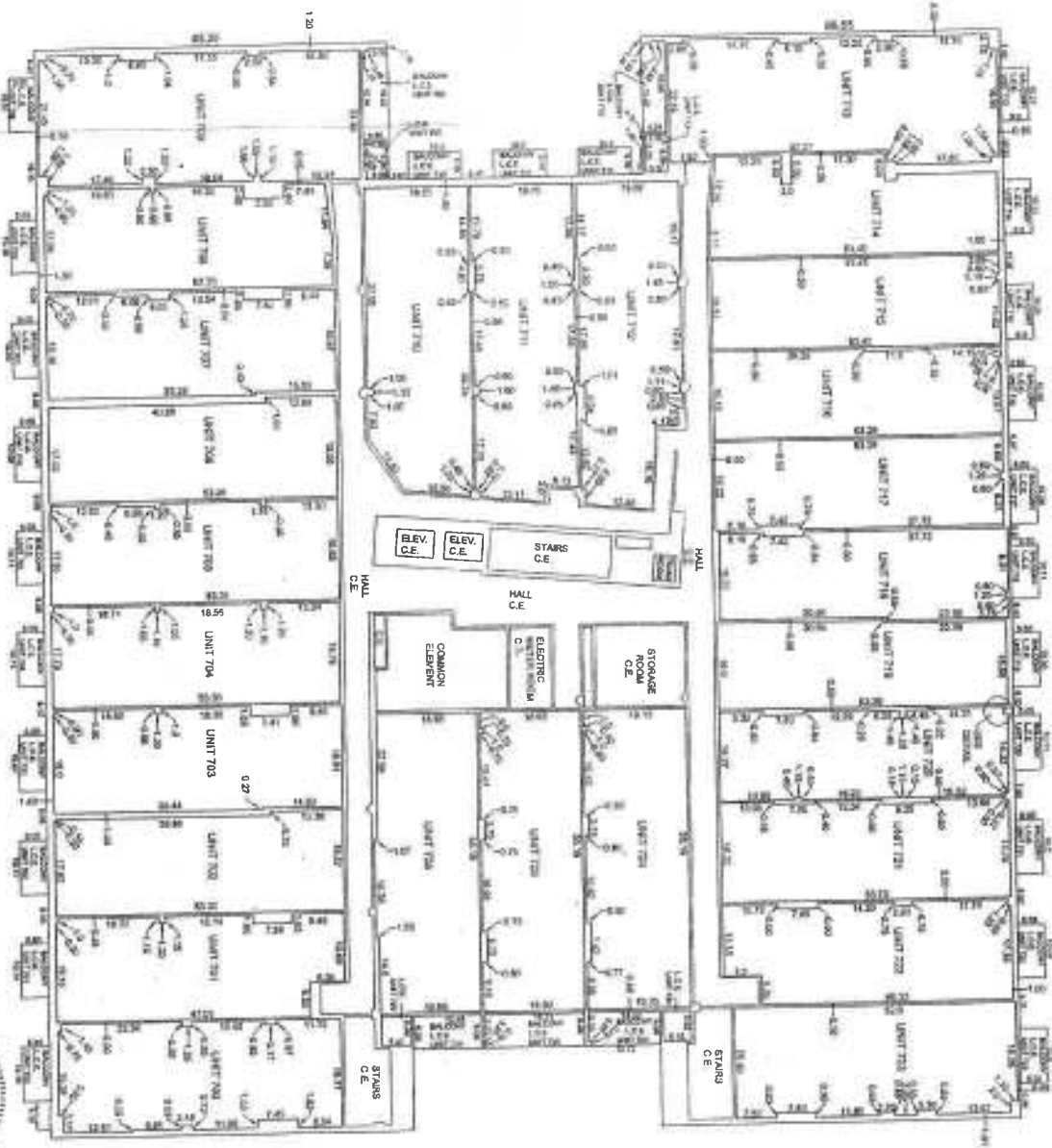

ORDER No. 0697
EXHIBIT A
PAGE 9

7th FLOOR

UNIT 720 AMENDED SEPTEMBER 13, 2007
UNIT 710 AND 724 AMENDED SEPTEMBER 21, 2007
UNIT 711 AMENDED APRIL 16, 2008
UNIT 718 AMENDED JUNE 16, 2008
UNIT 708 & 710 AMENDED FEBRUARY 20, 2008
UNIT 722 AMENDED FEBRUARY 14, 2008
UNIT 715 AMENDED JUNE 16, 2008
UNIT 716 AMENDED JUNE 16, 2008
UNIT 717 AMENDED JUNE 16, 2008
UNIT 719 AMENDED JUNE 16, 2008
UNIT 721 AMENDED JUNE 16, 2008
UNIT 723 AMENDED JUNE 16, 2008
UNIT 724 AMENDED JUNE 16, 2008
UNIT 725 AMENDED JUNE 16, 2008
UNIT 726 AMENDED JUNE 16, 2008
UNIT 727 AMENDED JUNE 16, 2008
UNIT 728 AMENDED JUNE 16, 2008
UNIT 729 AMENDED JUNE 16, 2008
UNIT 730 AMENDED JUNE 16, 2008
UNIT 731 AMENDED JUNE 16, 2008
UNIT 732 AMENDED JUNE 16, 2008
UNIT 733 AMENDED JUNE 16, 2008
UNIT 734 AMENDED JUNE 16, 2008
UNIT 735 AMENDED JUNE 16, 2008
UNIT 736 AMENDED JUNE 16, 2008
UNIT 737 AMENDED JUNE 16, 2008
UNIT 738 AMENDED JUNE 16, 2008
UNIT 739 AMENDED JUNE 16, 2008
UNIT 740 AMENDED JUNE 16, 2008
UNIT 741 AMENDED JUNE 16, 2008
UNIT 742 AMENDED JUNE 16, 2008
UNIT 743 AMENDED JUNE 16, 2008
UNIT 744 AMENDED JUNE 16, 2008
UNIT 745 AMENDED JUNE 16, 2008
UNIT 746 AMENDED JUNE 16, 2008
UNIT 747 AMENDED JUNE 16, 2008
UNIT 748 AMENDED JUNE 16, 2008
UNIT 749 AMENDED JUNE 16, 2008
UNIT 750 AMENDED JUNE 16, 2008
UNIT 751 AMENDED JUNE 16, 2008
UNIT 752 AMENDED JUNE 16, 2008
UNIT 753 AMENDED JUNE 16, 2008
UNIT 754 AMENDED JUNE 16, 2008
UNIT 755 AMENDED JUNE 16, 2008
UNIT 756 AMENDED JUNE 16, 2008
UNIT 757 AMENDED JUNE 16, 2008
UNIT 758 AMENDED JUNE 16, 2008
UNIT 759 AMENDED JUNE 16, 2008
UNIT 760 AMENDED JUNE 16, 2008
UNIT 761 AMENDED JUNE 16, 2008
UNIT 762 AMENDED JUNE 16, 2008
UNIT 763 AMENDED JUNE 16, 2008
UNIT 764 AMENDED JUNE 16, 2008
UNIT 765 AMENDED JUNE 16, 2008
UNIT 766 AMENDED JUNE 16, 2008
UNIT 767 AMENDED JUNE 16, 2008
UNIT 768 AMENDED JUNE 16, 2008
UNIT 769 AMENDED JUNE 16, 2008
UNIT 770 AMENDED JUNE 16, 2008
UNIT 771 AMENDED JUNE 16, 2008
UNIT 772 AMENDED JUNE 16, 2008
UNIT 773 AMENDED JUNE 16, 2008
UNIT 774 AMENDED JUNE 16, 2008
UNIT 775 AMENDED JUNE 16, 2008
UNIT 776 AMENDED JUNE 16, 2008
UNIT 777 AMENDED JUNE 16, 2008
UNIT 778 AMENDED JUNE 16, 2008
UNIT 779 AMENDED JUNE 16, 2008
UNIT 780 AMENDED JUNE 16, 2008
UNIT 781 AMENDED JUNE 16, 2008
UNIT 782 AMENDED JUNE 16, 2008
UNIT 783 AMENDED JUNE 16, 2008
UNIT 784 AMENDED JUNE 16, 2008
UNIT 785 AMENDED JUNE 16, 2008
UNIT 786 AMENDED JUNE 16, 2008
UNIT 787 AMENDED JUNE 16, 2008
UNIT 788 AMENDED JUNE 16, 2008
UNIT 789 AMENDED JUNE 16, 2008
UNIT 790 AMENDED JUNE 16, 2008
UNIT 791 AMENDED JUNE 16, 2008
UNIT 792 AMENDED JUNE 16, 2008
UNIT 793 AMENDED JUNE 16, 2008
UNIT 794 AMENDED JUNE 16, 2008
UNIT 795 AMENDED JUNE 16, 2008
UNIT 796 AMENDED JUNE 16, 2008
UNIT 797 AMENDED JUNE 16, 2008
UNIT 798 AMENDED JUNE 16, 2008
UNIT 799 AMENDED JUNE 16, 2008
UNIT 800 AMENDED JUNE 16, 2008

DOCUMENT WITH THIS EXHIBIT

DEF.

HORIZONTAL DIMENSIONS SHOWN ARE MEASURED FROM THE TOP OF UNFINISHED FLOOR TO THE BOTTOM OF UNFINISHED CEILING.
VERTICAL DIMENSIONS SHOWN ARE MEASURED FROM INTERIOR FACE OF UNFINISHED FOUNDATION WALLS.
ELEVATIONS SHOWN HEREON ARE IN RELATION TO:
ELEVATION = +18.822
UNITS ELEVATION = +18.70 ON THIS PAGE ONLY
LOWEST ELEVATION = +8.50 ON THIS PAGE ONLY.



STATE OF ILLINOIS
COUNTY OF COOK SS
WE, CERTIFIED SURVEYORS, HEREBY CERTIFY THAT WE HAVE CONDUCTED A SURVEY OF THE ABOVE DESCRIBED PROPERTY AND THAT THE DIMENSIONS AND BEARINGS SHOWN ON THE ATTACHED PLAT WHICH IS A TRUE AND CORRECT REPRESENTATION OF SAID SURVEY. ALL DISTANCES, DIMENSIONS AND ELEVATIONS AND BEARINGS SHOWN ON THIS PLAT ARE IN ACCORDANCE WITH THE PROVISIONS OF THE SURVEYING ACT AND THE REGULATIONS OF THE BOARD OF SURVEYING AND ENGINEERING. WE HEREBY CERTIFY THAT THIS PLAT IS A TRUE AND CORRECT REPRESENTATION OF SAID SURVEY AND THAT WE ARE NOT PROVIDING ANY OTHER INFORMATION ON THIS PLAT.
DATE: 11/15/08
BY: [Signature]
LICENSE EXPIRES NOVEMBER 30, 2008