

1440 Renaissance Drive, Suite 140, Park Ridge, IL 60068 Phone 847-296-6900 Fax 847-296-6906
PLAT OF SURVEY

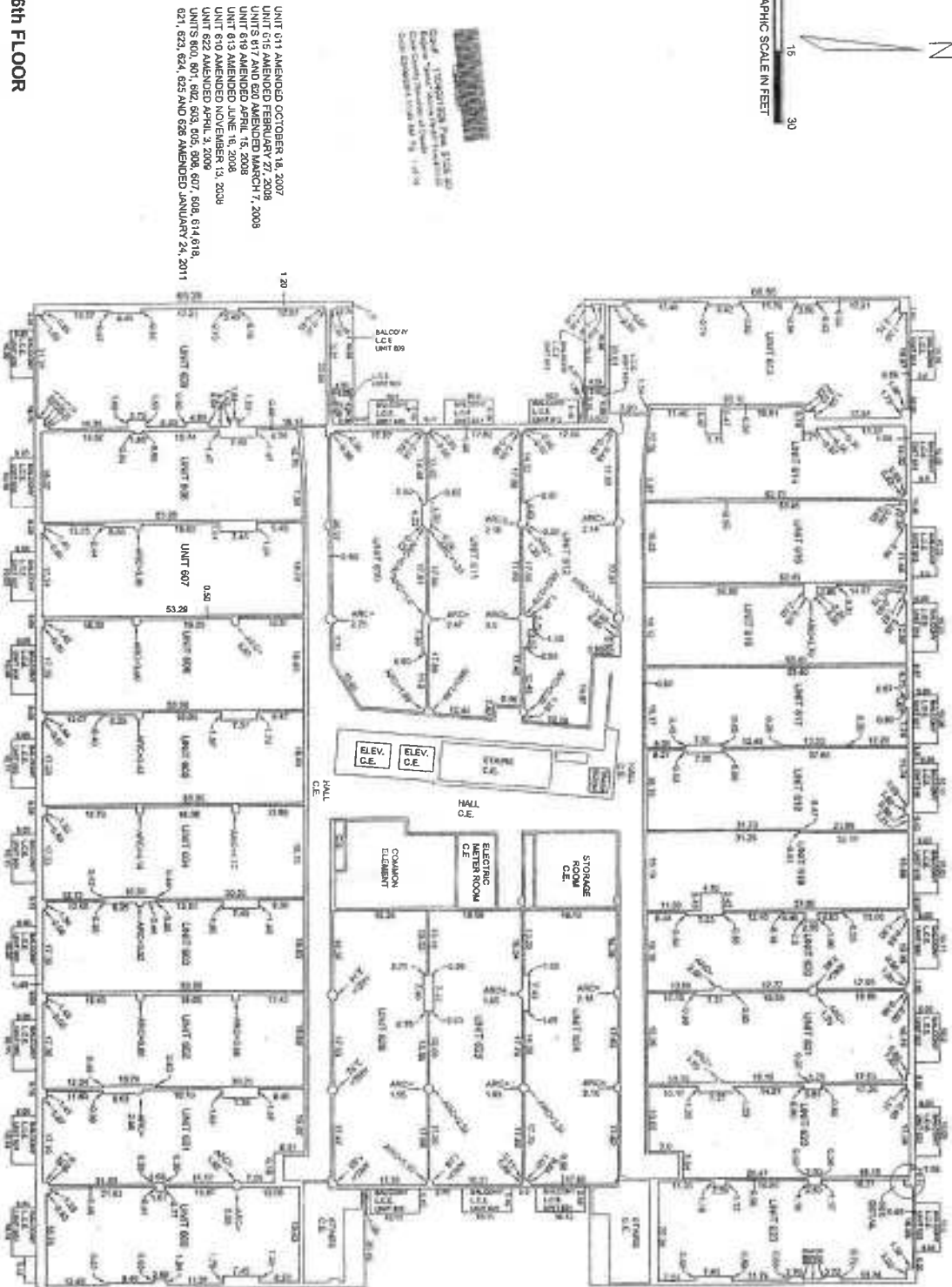

DOCUMENT WITH THIS EXHIBIT

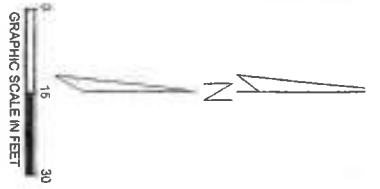

HORIZONTAL PLANES SHOWN HEREON ARE MEASURED FROM THE TOP OF UNFINISHED FLOOR TO THE BOTTOM OF UNFINISHED CEILING.
 VERTICAL PLANES SHOWN HEREON ARE MEASURED FROM INTERIOR FACE OF UNFINISHED PERIMETER WALLS.
 ELEVATIONS SHOWN HEREON ARE IN RELATION TO:
 BENCHMARK NO. 3982
 1.20 FEET NORTH OF NORTH LINE OF W. ADAMS STREET AND ABOUT ON EAST LINE OF S. PULASKI AVENUE
 MARK CUT AT SOUTHWEST CORNER OF STONE BUILDING ON WEST SIDE OF 2 STORY BRICK BUILDING, MARK IS 3.0 FEET ABOVE SIDEWALK
 ELEVATION = +18.622
 UPPER ELEVATION = 88.88 ON THIS PAGE ONLY.
 LOWER ELEVATION = 88.88 ON THIS PAGE ONLY.

STATE OF ILLINOIS
 COUNTY OF COOK SS

WE, CERTIFIED SURVEYOR INC., HEREBY CERTIFY THAT WE HAVE SURVEYED THE ABOVE DESCRIBED PROPERTY, LOCATED THE BUILDING THEREON AND DIVIDED BOTH VERTICALLY AND HORIZONTALLY AS A CONDOMINIUM AS CORRECTLY REPRESENTED BY THIS SURVEY. ALL DISTANCES, DIMENSIONS AND ELEVATIONS ARE GIVEN IN FEET AND DECIMAL PARTS OF A FOOT. THIS PROFESSIONAL SERVICE CONFORMS TO THE CURRENT ILLINOIS MINIMUM STANDARDS FOR BOUNDARY SURVEYS AND CONDOMINIUMS.
 DATED THIS 15th DAY OF JULY, A.D. 2007



PROFESSIONAL ILLINOIS LAND SURVEYOR #2777
 LICENSE EXPIRES NOVEMBER 30, 2008